

ARIEL

Whirlpool Installation Manual

ARIEL

PW1545930LW1

PW1545930RW1

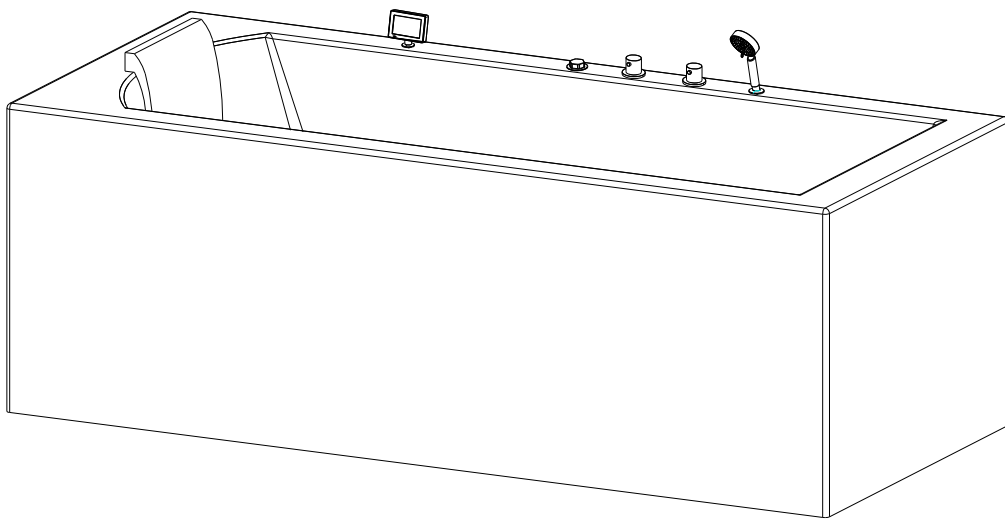

Serial Number:

L

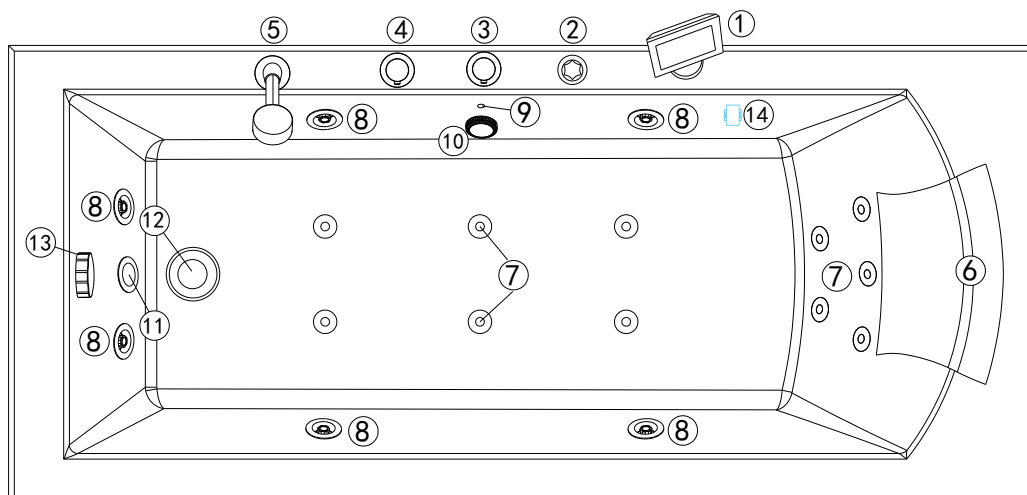

R

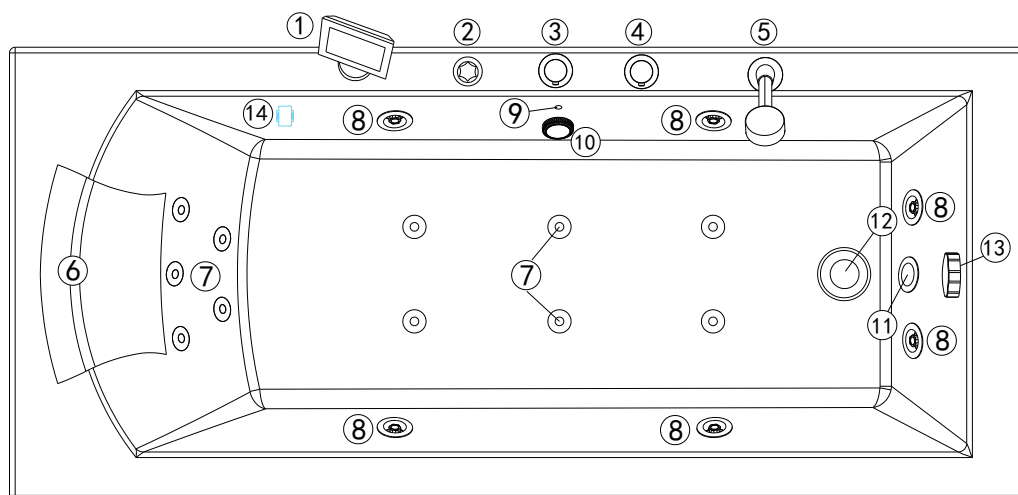

No.	English	No.	English
1	Control Panel	8	Multiple Direction Water Jet
2	Air Regulator	9	Temperature Sensor
3	Thermostatic Selector	10	Water Suction
4	Function Selector	11	LED Underwater Lamp
5	Shower Wand	12	Drain
6	Headrest	13	Overflow Drain & Drain Knob
7	Water Jet	14	Water Level Sensor (Backside)

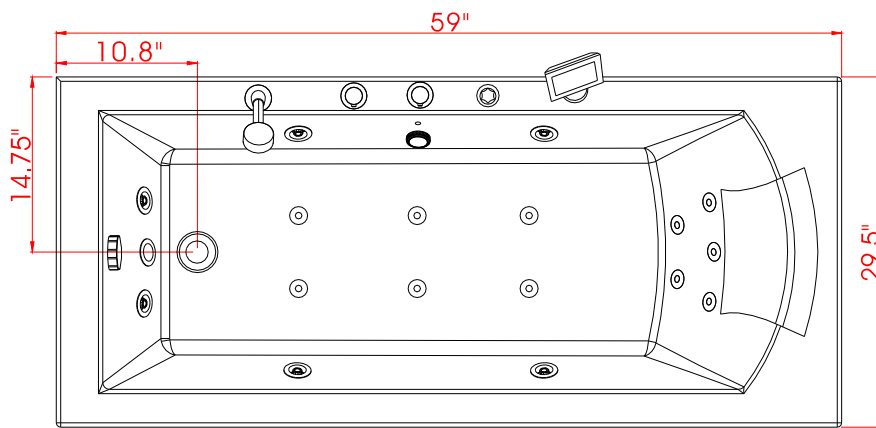

***Actual Drain-Cutout Location**

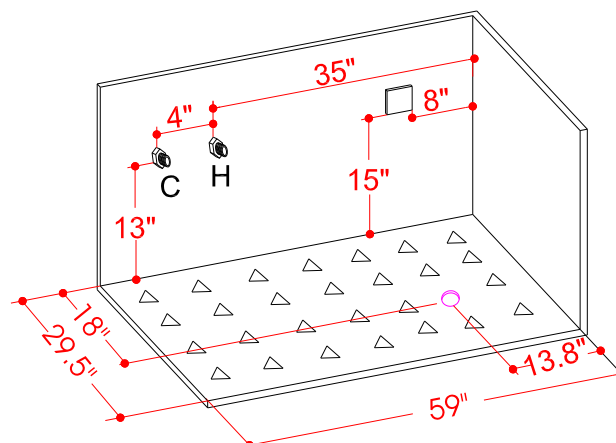
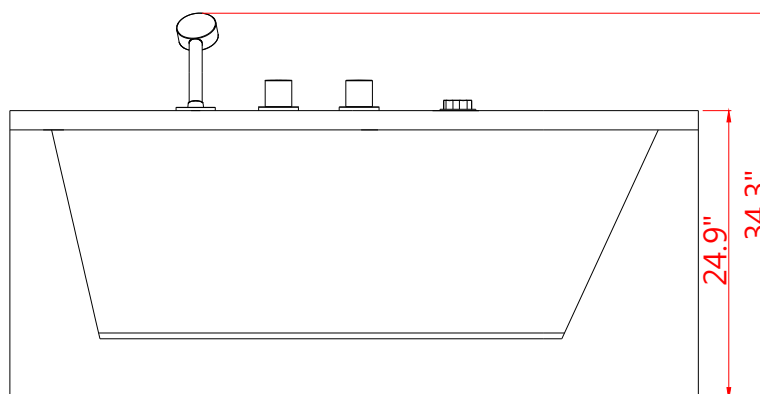
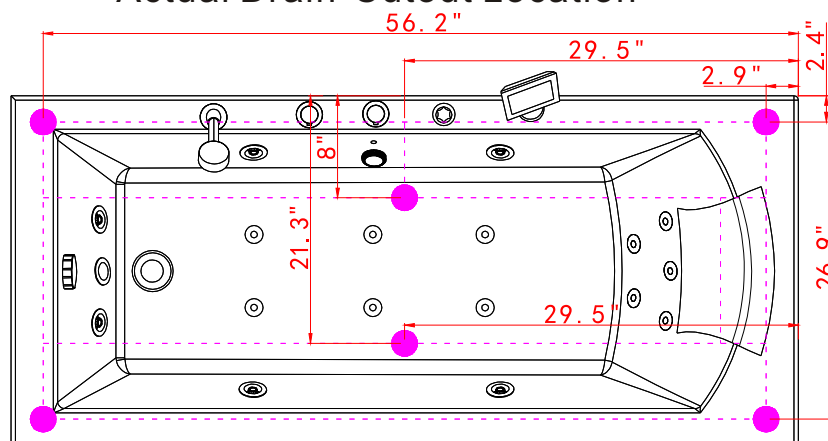

***Optional: Flex-Drain Drain Location**

All measurements are given in Inches
 Designs and sizes can vary. We accept no liability for errors,
 manufacturing tolerance and product changes.

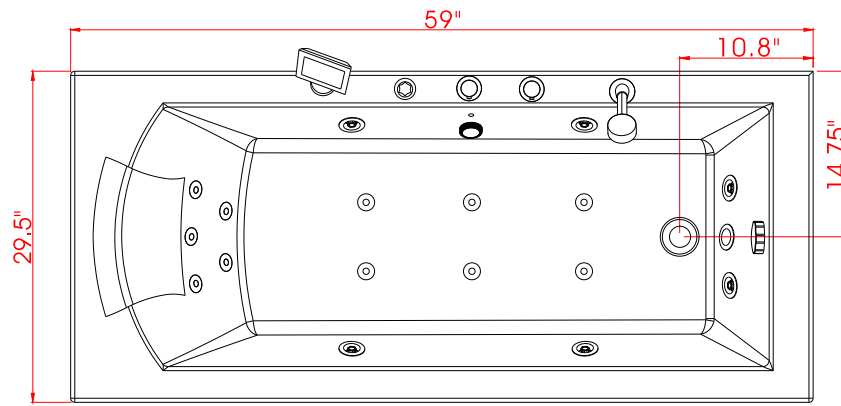

***Actual Drain-Cutout Location**

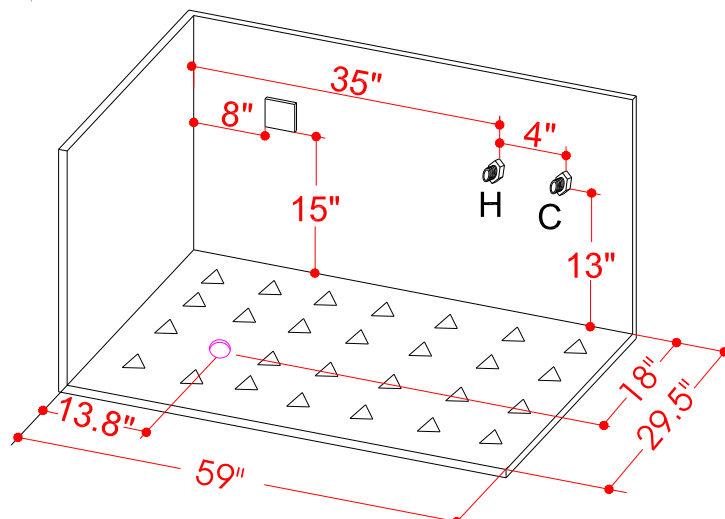
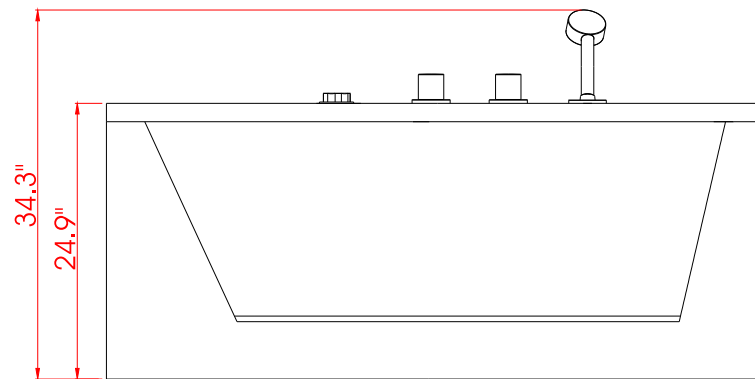
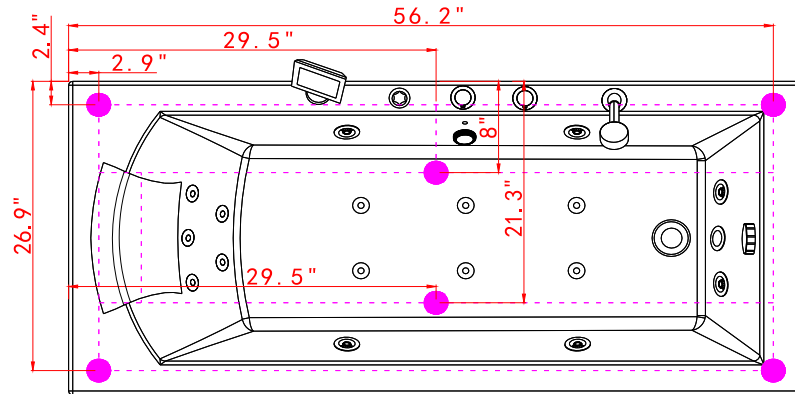

***Optional: Flex-Drain Drain Location**

All measurements are given in Inches
 Designs and sizes can vary. We accept no liability for errors,
 manufacturing tolerance and product changes.

1

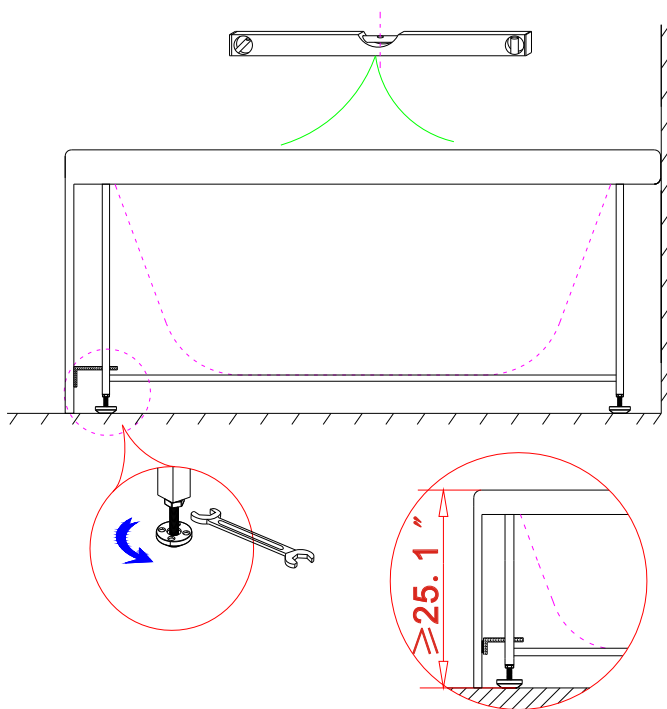

2

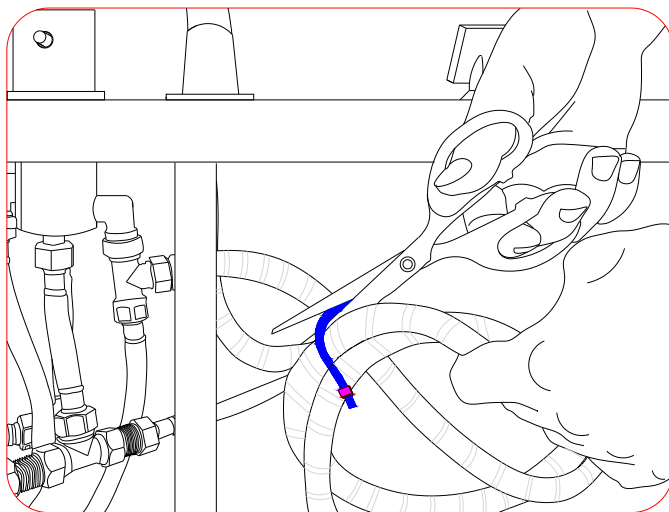

3

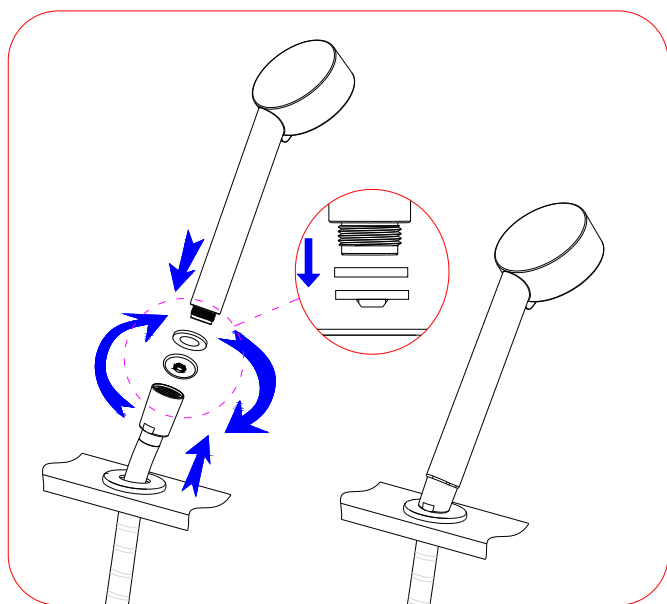

4

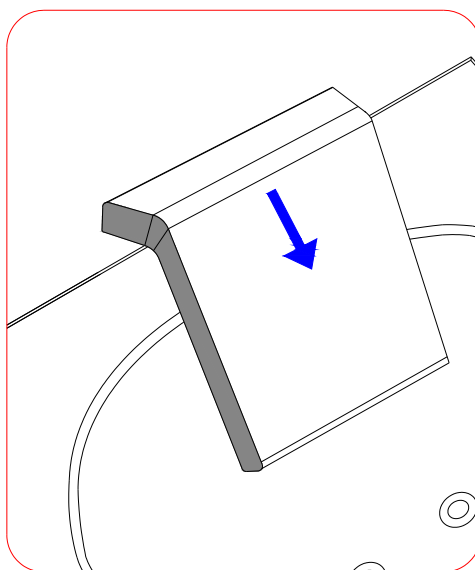

5

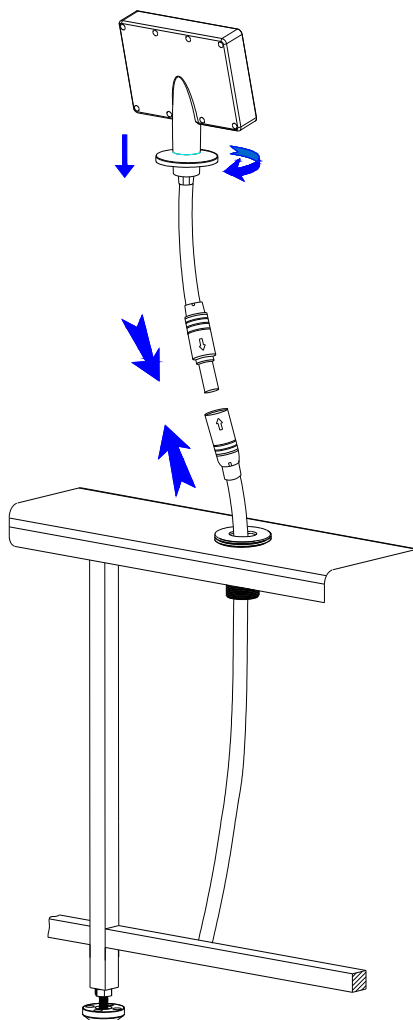

6

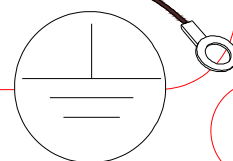
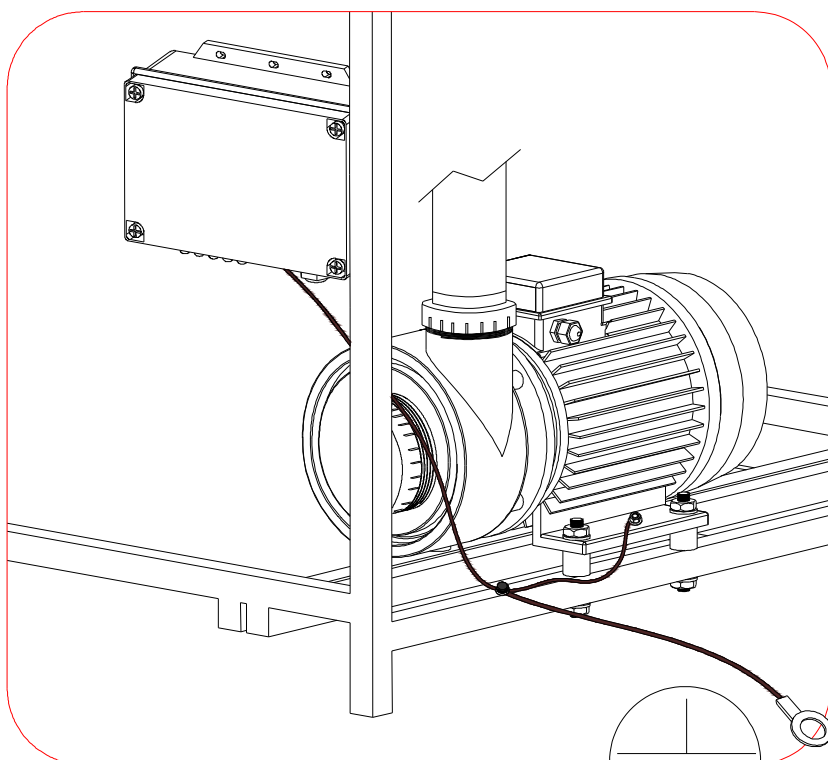

7

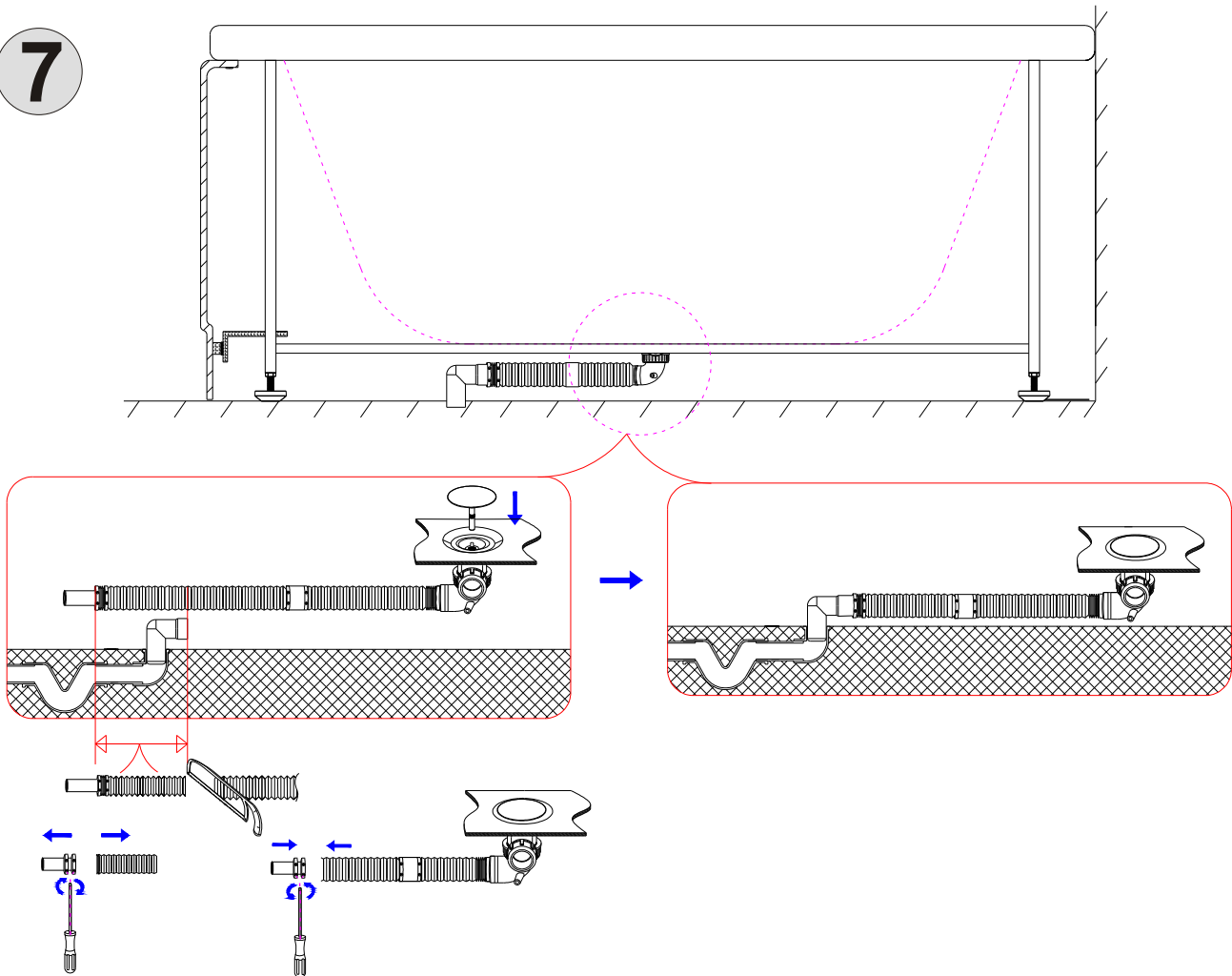

*Some optional features maybe shown: Flex-Drain Hose

8

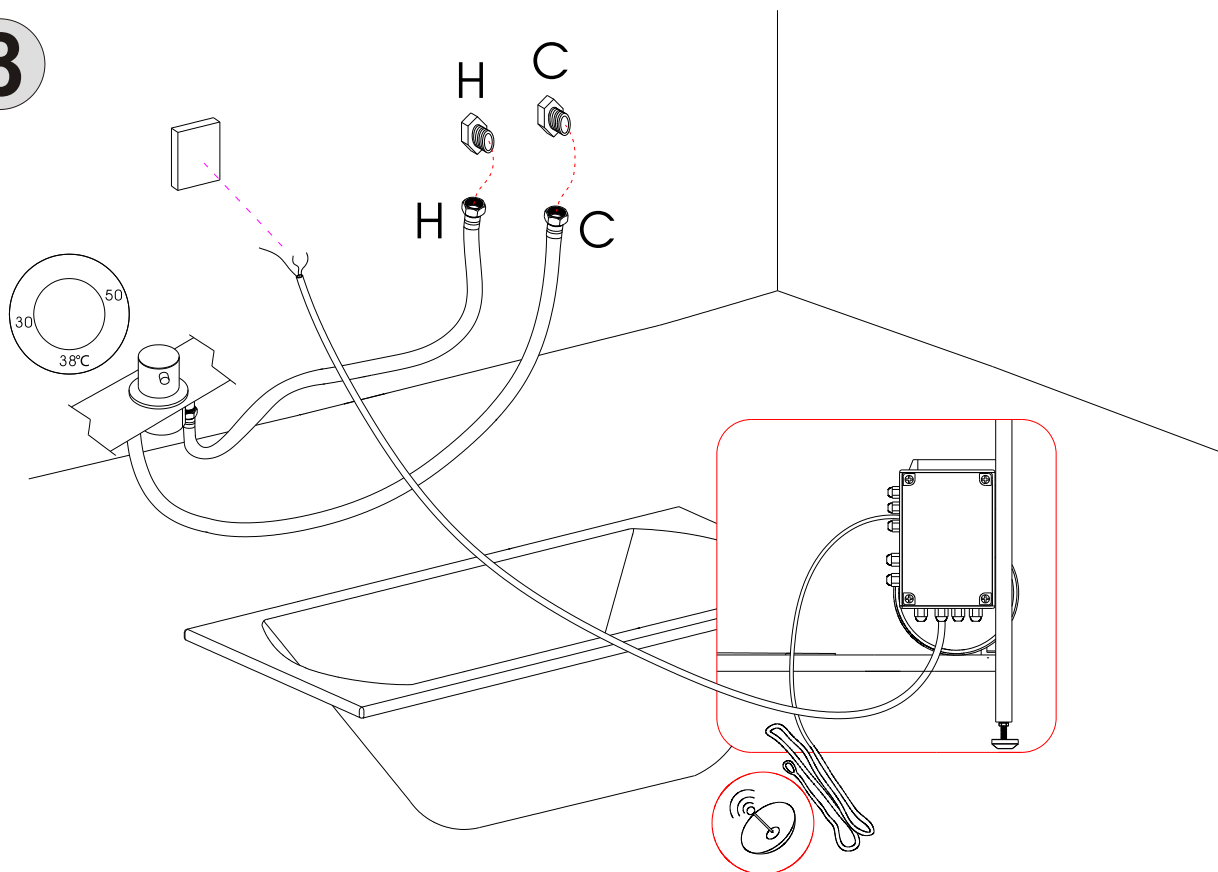

9

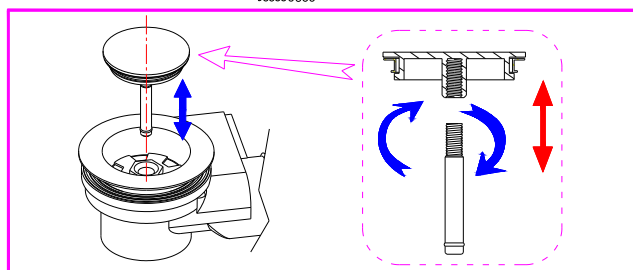
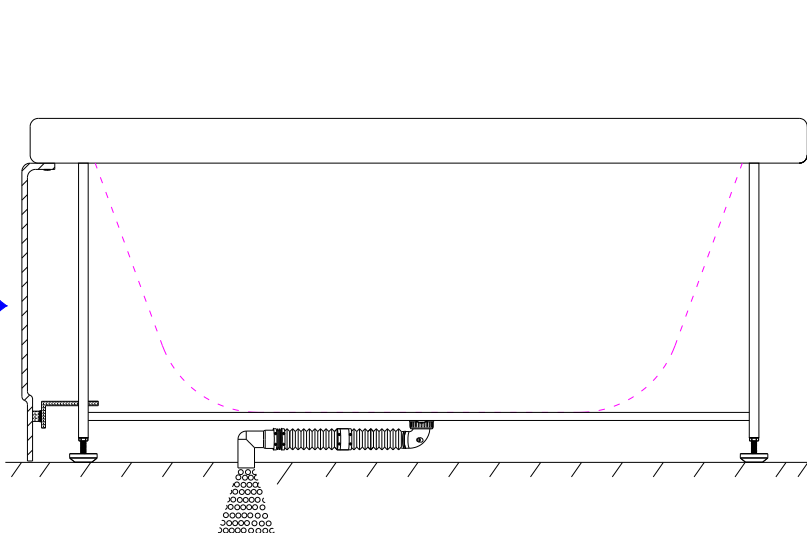
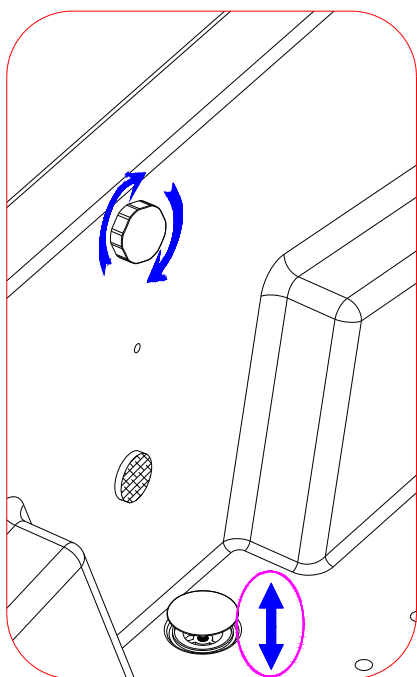

10

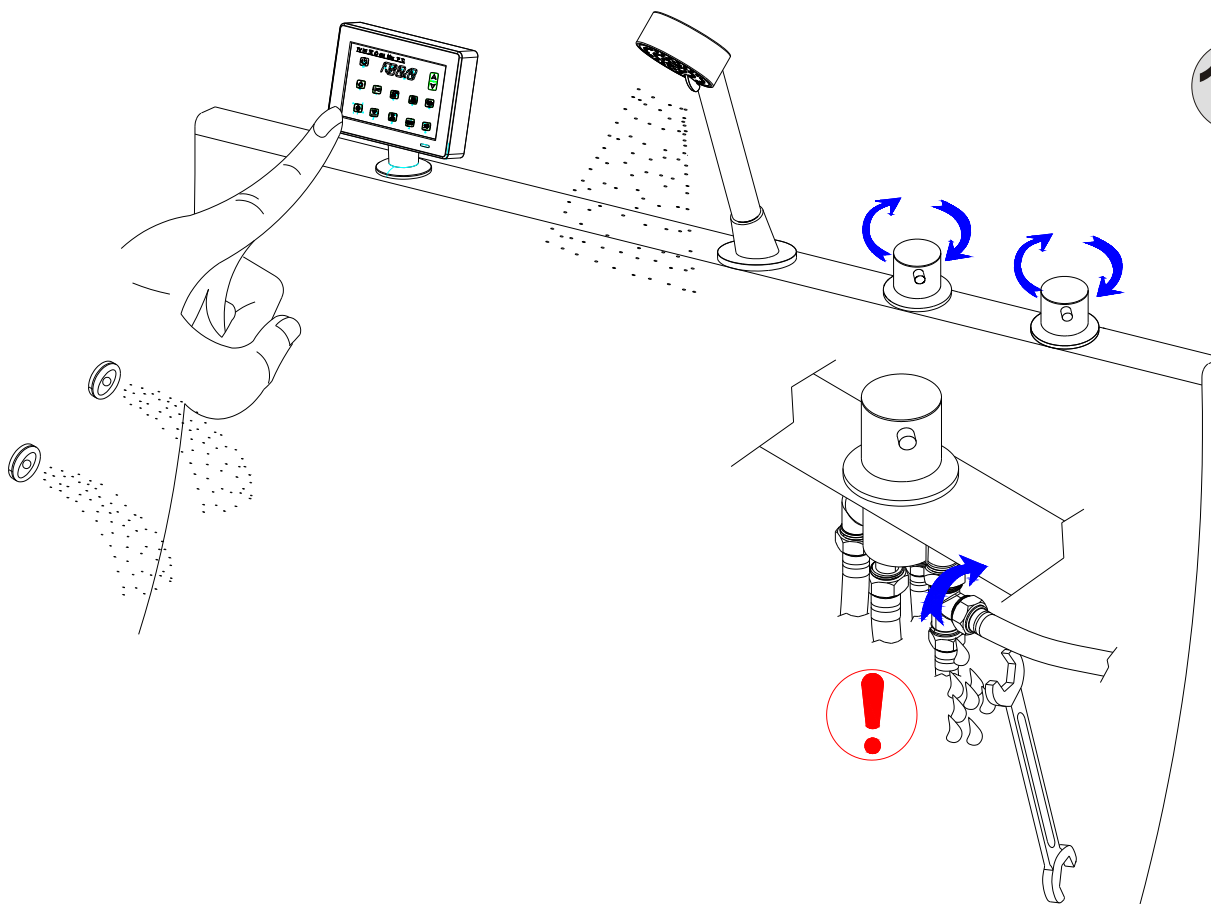

Technical Parameters

Rated Voltage	AC110-120V 60Hz
Rated Current	23.6A
Normal Rated Power	2600W
Recommended Power Service	GFCI-Protected 30A
Water Pipe Dimension	1/2"
Drainage Pipe Dimension	1 1/2" (40mm)
Max. Hot Water Temperature	176°F (80°C)
Recommended Hot Water	149°F (65°C)
Operating Pressure	Max 116 PSI (8 bar / 0.8 mPa)
Recommended Operating Pressure	14.5-72.5 PSI (1-5 bar / 0.1-0.5mPa)

Flowchart

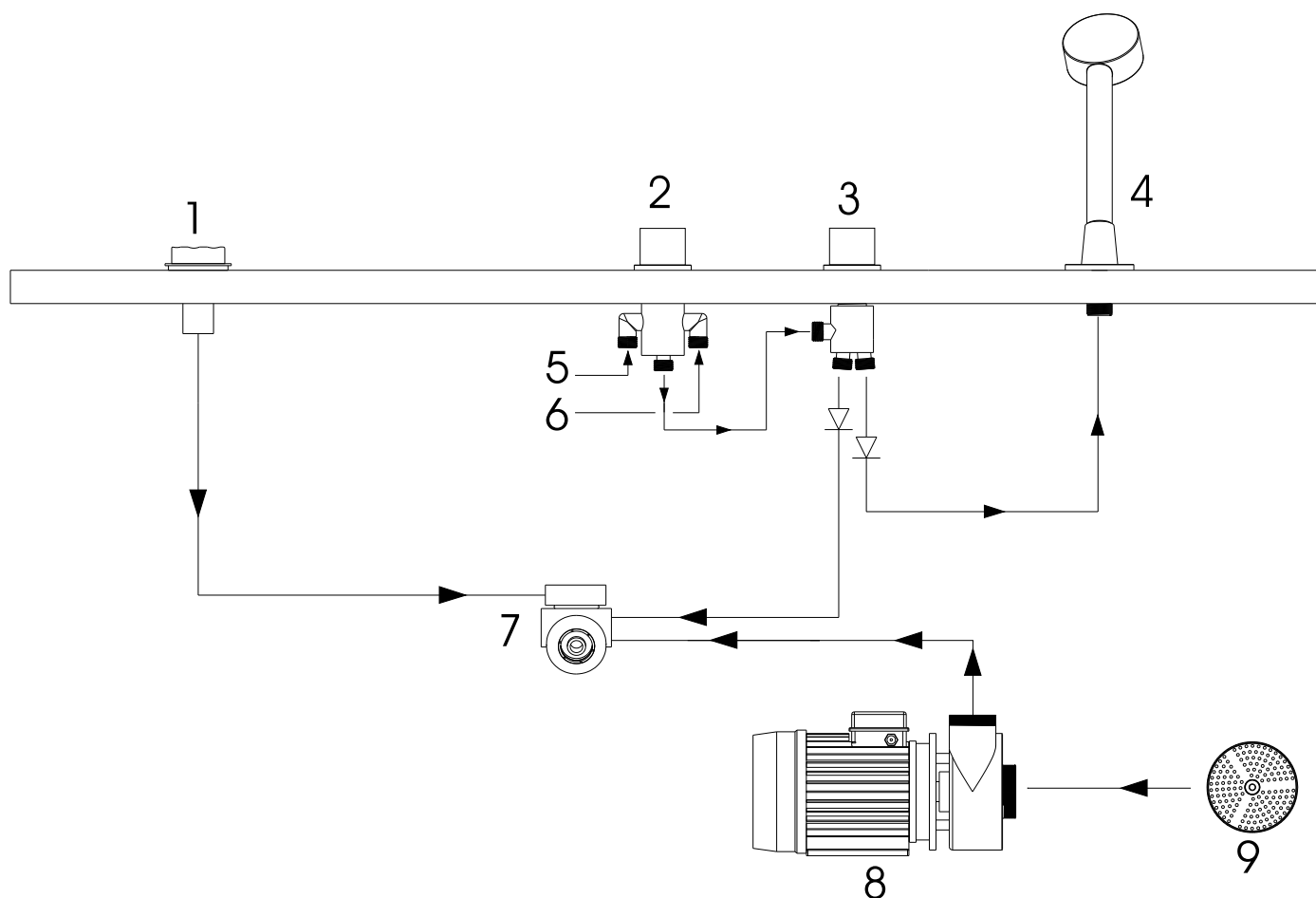

No.	English	No.	English
1	Air Regulator	6	Hot Water Supply Inlet
2	Thermostatic Selector	7	Water Jet
3	Function Selector	8	Water Pump
4	Shower Wand	9	Water Suction
5	Cold Water Supply Inlet		

Electrical Wiring Diagram

